

Model **59550**

EL[®]MARK

Owner's Manual & Safety Instructions

Cordless Drill



⚠ WARNING

Read this manual before using this product.
Failure to do so can result in serious injury.
SAVE THIS MANUAL.



DESCRIPTION OF THE TOOL

OPERATING CONTROL



The tool is intended for driving in and loosening screws as well as for drilling in wood, metal, ceramic and plastic.

1. MAIN PARTS

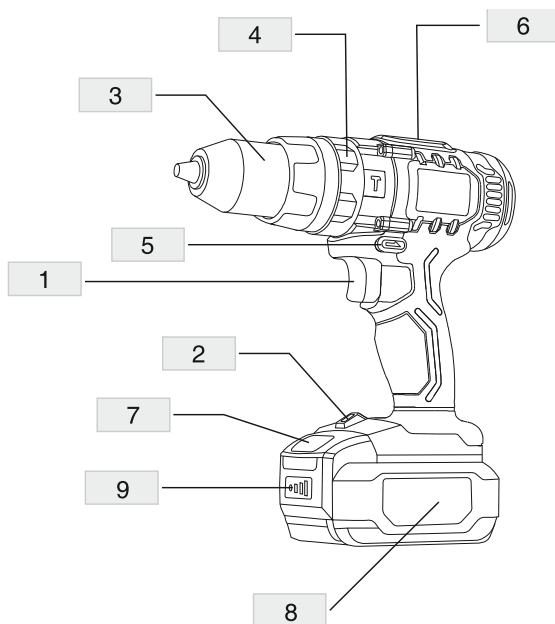

1. On/Off switch
2. Worklight
3. Keyless chuck
4. Torque-adjustment ring
(95702 with impact function)
5. Direction-of-rotation switch
6. Two speed adjustment switch
7. Battery pack release button
8. Battery pack
9. Power display button
10. Charger
11. Charger indicator

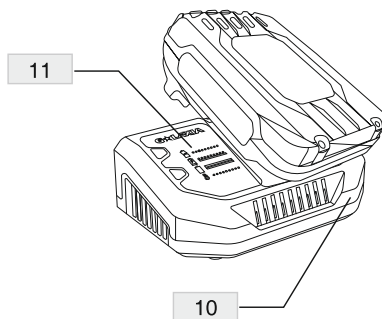

2、TOOL SPECIFICATIONS

Model	59550
Rated voltage(V)	20
No load speed(min ⁻¹)	0-400/0-1500
Impact rate(BPM)	/
Max torque(N.m)	30
Chuck size(mm)	10

GENERAL SAFETY RULES

⚠ WARNING: Read all instructions. Failure to follow all instructions listed below may result in electric shock, fire and/or serious personal injury.

SAVE THESE INSTRUCTIONS

The term “power tool” in all of the warnings listed below refers to your mains operated (corded) power tool or battery operated (cordless) power tool.

1.Workplace

- 1) Keep workplace clean and well lit. Cluttered and dark workplaces invite accidents.
- 2) Do not operate power tools in explosive atmospheres, such as in the presence of flammable liquids, gases or dust. Power tools create sparks which may ignite the dust or fumes.
- 3) Keep children and bystanders away while operating a power tool. Distractions can cause you to lose control.

2.Electrical safety

- 1)Power tool plugs must match the outlet. Never modify the plug in any way. Do not use any adapter plugs with earthed (grounded) power tools. Unmodified plugs and matching outlets will reduce risk of electric shock.
- 2)Avoid body contact with earthed or grounded surfaces such as conduits, radiators, and refrigerators. There is an increased risk of electric shock if your body is earthed or grounded.
- 3)Do not expose power tools to rain or wet conditions. Water entering a power tool will increase the risk of electric shock.
- 4)Do not abuse the cord. Never use the cord for carrying, pulling or unplugging the power tool. Keep

cord away from heat oil, sharp edges or moving parts. Damaged or entangled cords increase the risk of electric shock.

5)When operating a power tool outdoors, use an extension cord suitable for outdoor use. Use of a cord suitable for outdoor use reduces the risk of electric shock.

3.Personal safety

- 1)Stay alert, watch what you are doing and use common sense when operating a power tool. Do not use a power tool while you are tired or under the influence of drugs, alcohol or medication. A moment of inattention while operating power tools may result in serious personal injury.
- 2)Use safety equipment. Always wear eye protection. Safety equipment such as dust mask, non- skid safety shoes, hard hat, or hearing protection used for appropriate conditions will reduce personal injuries.
- 3)Avoid suddenly starting. Ensure the switch is in the off position before plugging in. When your finger on the switch or plugging in power tools that have the switch on invites accidents.
- 4)Remove any adjusting key or wrench before turning the power tool on. A wrench or a key left attached to a rotating part of the power tool may result in personal injury.
- 5)Do not overreach. Keep proper footing and balance at all times. This enables better control of the power tool in unexpected situations.
- 6)Dress properly. Do not wear loose clothing or jewellery. Keep your hair, clothing and gloves away from moving parts. Loose clothes, jewellery or long hair can be caught in moving parts.
- 7)If devices are provided for the connection of dust extraction and collection facilities, ensure these are connected and properly used. Use of these devices can reduce dust related hazards.

4.Power tool use and care

1) Do not force the power tool. Use the correct power tool for your application. The correct power tool will do the job better and safer at the rate for which it was designed.

2) Do not use the power tool if the switch does not turn it on and off. Any power tool that cannot be controlled with the switch is dangerous and must be repaired.

3) Disconnect the plug from the power source before making any adjustments, changing accessories, or storing power tools. Such preventive safety measures reduce the risk of starting the power tool accidentally.

4) Store idle power tools out of the reach of children and do not allow persons unfamiliar with the power tool or these instructions to operate the power tool. Power tools are dangerous in the hands of untrained users.

5) Maintain power tools. Check for misalignment or binding of moving parts, breakage of parts and any other condition that may affect the power tools operation. If damaged, have the power tool repaired before use. Many accidents are caused by poorly maintained power tools.

6) Keep cutting tools sharp and clean. Properly maintained cutting tools with sharp cutting edges are less likely to bind and are easier to control.

7) Use the power tool, accessories and tool bits etc., in accordance with these instructions and in the manner intended for the particular type of power tool, taking into account the working conditions and the work to be performed. Use of the power tool for operations different from those intended could result in a hazardous situation.

5. Battery tool use and care

1) Recharge only with the charger specified by the manufacturer. A charger that is suitable for one type of battery pack may create a risk of fire when used with another battery pack.

2) Use power tools only with specifically designated battery packs. Use of any other battery packs may create a risk of injury and fire.

3) When battery pack is not in use, keep it away from other metal objects, like paper clips, coins, keys, nails, screws or other small metal objects that can make a connection from one terminal to another. Shorting the battery terminals together may cause burns or a fire.

4) Under abusive conditions, liquid may be ejected from the battery; avoid contact. If contact accidentally occurs, flush with water. If liquid contacts eyes, additionally seek medical help. Liquid ejected from the battery may cause irritation or burns.

6. Service

1) Have your power tool serviced by a qualified repair person using only identical replacement parts. This will ensure that the safety of the power tool is maintained.

SAFETY RULES FOR BATTERY PACK

1. Avoid unintentional switching on, ensure the on/off switch is in the off position before inserting battery pack. Carrying the power tool with your finger on the on/ off switch or inserting the battery pack into power tools that have the switch on invites accidents.

2. Do not open the battery. Danger of short-circuiting.

3. Protect the battery against heat, e.g., also against continuous sun irradiation and fire. There is danger of explosion.

4. In case of damage and improper use of the battery, vapors may be emitted. Provide for fresh air and seek medical help in case of complaints. The vapors can irritate the respiratory system.

5. When the battery is defective, liquid can escape and come into contact with adjacent components. Check any parts concerned. Clean such parts or replace them, if required.

6. Use the battery only in conjunction with your FLEX power tool. This measure alone protects the battery against dangerous overload.

7. Only use the battery with the **ELMARK** charger.

8. Do not crush, drop or damage the battery pack. Do not use a battery pack or charger that has been dropped or received a sharp blow. A damaged battery is subject to explosion. Properly dispose of a dropped or damaged battery immediately.

9. Do not charge a battery tool in a damp or wet location. Following this rule will reduce the risk of electric shock.

SAFETY RULES FOR CHARGER

1. Protect the battery charger from rain and moisture. Water penetration in a battery charger increases the risk of electric shock.

2. Do not charge other batteries. The battery charger is suitable only for charging FLEX lithium-ion batteries within the listed voltage range. Otherwise there is danger of fire and explosion.

3. Keep the battery charger clean. Contamination may increase the risk of electric shock.

4. Before using, always check the charger, cable and plug. If defects are detected, do not use the charger; never open the charger. Instead, have it opened and repaired only by qualified personnel who will use original spare parts. Damaged chargers, cables and plugs increase the risk of electric shock.

5. Do not operate the charger on easily inflammable surface (e.g. paper, textiles, etc.) or combustible surroundings. The heating of the charger during

charging may cause a fire.

6.Plug the charger within the listed voltage range on the charger.

7.Unplug the charger from the electrical outlet before attempting any maintenance or cleaning to reduce the risk of electric shock.

8.Disconnect charger form the power supply when not in use. This will reduce the risk of electric shock or damage to the charger if metal items should fall into the opening.

9.Risk of electric shock. Do not touch the un-insulated portion of output connector or un-insulated battery terminal.

ADDITIONAL SAFETY RULES FOR DRILL

1.Use suitable detectors to determine if utility lines are hidden in the work area or call the local utility company for assistance. Contact with electric lines can lead to fire and electric shock. Damaging a gas line can lead to explosion. Penetrating a water line causes property damage.

2.Switch off the power tool immediately when the tool inserts jams. Be prepared for high reaction torque that can cause kickback. The tool insert jams when:

- the power tool is subject to overload or
- it becomes wedged in the workpiece.

3.Hold the power tool only by the insulated grpping surfaces, when performing an operation where the cutting tool may run into hidden wiring. Contact with a "live" wire will make exposed metal parts of the tool "live" and shock the operator.

4.Hold the power tool with a firm grip. High reaction torque can briefly occur while driving in and loosening screws.

5.Secure the workpiece. A workpiece clamped with clamping devices or in a vice is held more secure than by hand.

6.Keep your workplace clean. Blends of materials are particularly dangerous. Dust from light alloys can burn or explode.

7.Always wait until the power tool has come to a complete stop before placing it down. The tool insert can jam and lead to loss of control over the power tool.

8.The tool can only be used with battery 5150 series together.

9.Never use the battery pack as a hammer, beat the battery pack could result in accident short, fire or explode.

⚠ WARNING: Some dust created by power Cutting contains chemicals known to cause cancer, birth defects or other reproductive harm. Some examples

of these chemicals are:

- lead from lead-based paints
- Arsenics and chromium from chemically reacted lumber.

Your risk from these exposures varies, depending on how often you do this type of work. To reduce your exposure to these chemicals: work in a well ventilated area, and work with approved safety equipment.

STANDARD ACCESSORIES

- Clip
- Charger
- Battery pack

Be sure to check the accessories as it is subject to change by areas and models.

OPERATION

1. Check the power voltage must be consistent with the nameplate data!

2. BATTERY CHARGING

The battery is supplied partially charged. To ensure full capacity of the battery, completely charge the battery in the battery charger before using your power tool for the first time.

- 1) Charge the Lithium-Ion battery pack with the correct charger.
- 2) Connect the charger to a power supply.
- 3) Align the raised ribs of the battery pack with the slot in the charger.
- 4) Slide the battery pack onto the charger.
- 5) The charger will communicate with the battery pack to evaluate the condition of the battery pack.
- 6) The green light flsshing and the red lights goes on is in charge state.
- 7) The red and green lights still on is the State of fullness
- 8) Red and green lights flicker alternately, the charger is not work

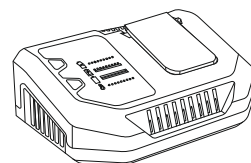

59562

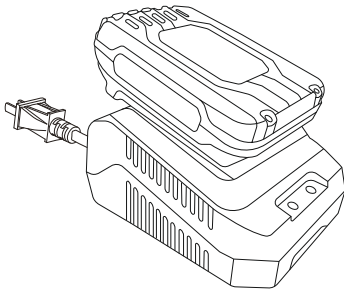

5. INSERTING THE BATTERY

⚠ WARNING: Use only FLEX lithium-ion batteries with the voltage listed on the nameplate of your power tool. Using other batteries can lead to injuries and pose a fire hazard.

NOTE: Use of batteries not suitable for the machine can lead to malfunctions of or cause damage to the power tool.

Set the rotational direction switch 5 to the center position in order to avoid unintentional starting. Align the raised rib on the battery pack with the grooves of the drill, and then attach the battery pack to the drill, until you hear “click” to indicate the battery pack is attached tightly.

3. LOW-BATTERY CAPACITY INDICATOR

If LED worklights on the POWER BAR begins to rapidly and continuously flash when the trigger switch on the wrench is depressed, the battery pack’s power has run out, and the battery pack should be recharged.

Unlike other battery pack types, Lithium-Ion battery packs deliver fade-free power for their entire run time. The tool will not experience a slow, gradual loss of power as you work. To signal that the battery pack is at the end of its run time and needs to be charged, the power to the tool will drop quickly. The POWER BAR will begin to display four flashing LED lights when the battery is completely discharged. When this happens, remove the tool from the workpiece, and charge the battery pack as needed.

4. CHANGING THE TOOL

WARNING: Before any work on the power tool (e.g., maintenance, tool change, etc.) as well as during transport and storage, set the rotational direction switch to the center position. Unintentional actuation of the on/off switch can lead to injuries. Hold the keyless chuck 3 firmly; turn it anti-clockwise, until the drilling bit can be inserted. Hold the keyless chuck 3 firmly; turn it clockwise to lock the bit in position.

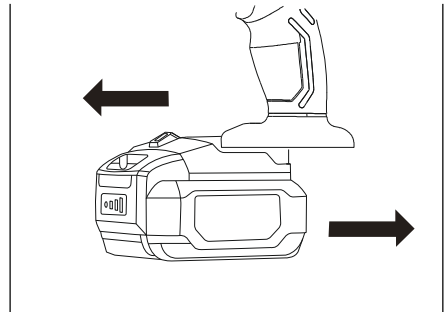
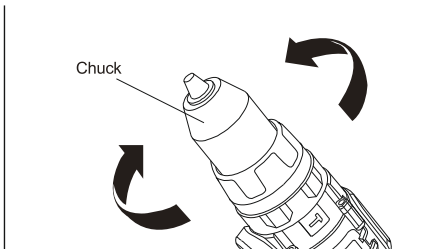

6. DIRECTION-OF ROTATION

The direction-of rotation switch (5) is used to reverse the rotational direction of the machine. However, this is not available when the on/off switch (1) actuated.

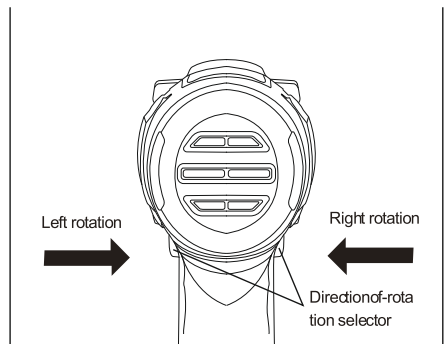

7.SETTING THE TORQUE

With the Torque-adjustment ring (4) the required torque setting can be preselected.

When using the drill for different driving applications, increase or decrease the torque in order to help prevent damaging screw, heads, threads, workpiece etc.

The proper setting depends on the job and the type of bit, and material you will be using. In general, use greater torque for larger screws. If the torque is too high, the screws may be damaged or broken.

For delicate operations, use a low torque setting. For operations such as drilling into hardwood, use a higher torque setting.

8.HAMMER/SCREW/DRILL MODSELECTION (5283)

Select hammer mode for hammering action,drill mode for drilling and other heavy duty applications, screw mode for driving or loosen screws.

To select the mode, rotate the hammer/ screw/drill mode selection ring until the icons or align with the indicator and clicks into position.the torque indicator and clicks into position.

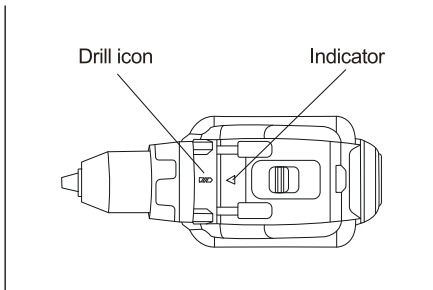

9.VARIABLE SPEED TRIGGER SWITCH

To start the tool, press the switch 1, and keep it pressed.

To switch the unit off, release the switch

The variable speed trigger switch delivers higher speed with increased trigger pressure and lower speed with decreased trigger pressure.

10.FULLY AUTOMATIC SPINDLE LOCKING

When the on/off switch 1 is not pressed, the drill spindle and thus the tool holder are locked. This enables screws to be screwed in, even when the battery is empty and allows for the tool to be used as a screwdriver.

11.MECHANICAL SPEED ADJUSTMENT

The drill has a two-speed gearbox designed for drilling or driving at LO or HI speeds.

Use LO speed for loosening or driving screws. HI speed is better for drilling holes.

12.WORKLIGHT INDICATOR

The worklight indicator (2) is lit when the trigger

switch (1) is depressed in whether the direction-of-rotation switch 5 is at the center position or at working time. It allows for illumination of the work area under unfavorable lighting conditions.

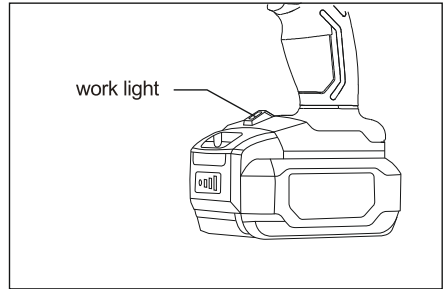

APPLICATIONS

⚠ WARNING: Apply the power tool to the screw only when it is switched off. Rotating tool inserts can slip off.

Check and make sure the direction-of rotation switch 5 is at the correct setting (left or right), hold the drill firmly on the insulated grip, and place the drill bit at the point to be drilled. Move the drill bit into the workpiece, applying only enough pressure to keep the bit cutting. Do not force the drill or apply side pressure to elongate a hole. Let the tool do the work.

NOTE: If the bit jams in the workpiece or if the drill stalls, stop the tool immediately. Remove the bit from the workpiece and determine the reason for jamming.

TOOL MAINTENANCE

⚠ WARNING: Before any work on the machine itself, remove the battery pack from the drill.

- 1.Inspect bolts periodically. If the bolts loosen, tighten them immediately, or will result in serious accident.
- 2.Inspect tool cords periodically. If damaged, have repaired at your nearest Authorized Service Center.
- 3.Keep the vents clean. Clean all parts of the tool, clean dust periodically. To prevent debris from entry.
- 4.All service **MUST** only be performed by Authorized Service Center. **ALWAYS** use only accessories that are recommended for this tool.
- 5.Cleaning. Avoid the use of plastic cracks caused by

damage to the solvent. Use clean cloths and mild soap to remove dirt, dust, etc.

 **WARNING:** Do not allow the water entering the motor and the tool full immersed in the ware, which will result in motor malfunction and electric shock.

ENVIRONMENT PROTECTION



- 1.Tool, accessories and packaging should be sorted for environment-friendly recycling.
- 2.Power tools and accessories at the end of their service life still contain large amounts of valuable raw materials and plastics which can likewise be fed back into a recycling process.
- 3.Some dust created by working contains harmful chemicals must be collected by special garbage recycle site.

SERVICE

- 1.In case of guarantee, repair or purchase of replacement parts, always contact the qualified service center. And supplied with the efficient service card and invoice.
- 2.It is without the scope of guarantee when the tool was normal wear, overload or improper use of damage.

Trouble shooting

Problems	Reasons	Ways to Solve The Problems
The drill does not work	Battery is depleted	Charge the battery
Bit cannot be installed	Sleeve is not released	Release the sleeve
Motor overheating	Be sure cooling vents are free from saw dust and obstacles	Clean, clear vents. Do not cover with hand during operation

ELMARK[®]

www.elmarkholding.eu

ELMARK FACTORY IN EUROPE

ELMARK INDUSTRIES SC
BULGARIA, DOBRICH
2 Dobrudja Blvd.
Tel: +359 58 500 059 +359 58 500 050
Fax: +359 58 500 060
E-mail: elmarkfactory@elmarkholding.eu

GENERAL REPRESENTATIVE FOR BULGARIA

ElektroMarket LTD
GRUP
BULGARIA, VARNA
ZPZ, 10 Perla Str.
Tel.: +359 52 57 55 57
Fax: +359 52 57 55 80
E-mail: officevarna@elmarkgroup.eu